

Clevis Pin

Product Specification Sheet

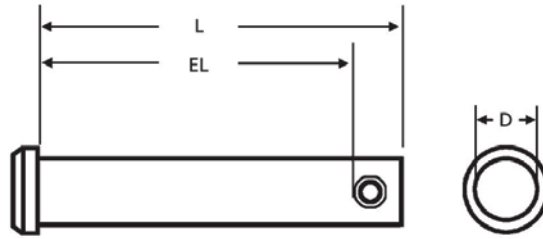

Part number	Dia	Length	EL
BFCLPS6-0187-2000	3/16	2	1.859
BFCLPS6-0187-3000	3/16	3	2.859
BFCLPS6-0250-0500	1/4	1/2	0.359
BFCLPS6-0250-0750	1/4	3/4	0.609
BFCLPS6-0250-2250	1/4	2 1/4	2.109
BFCLPS6-0250-2375	1/4	2 3/8	2.234
BFCLPS6-0312-1250	5/16	1 1/4	1.031
BFCLPS6-0312-1375	5/16	1 3/8	1.156
BFCLPS6-0312-1750	5/16	1 3/4	1.609
BFCLPS6-0312-2000	5/16	2	1.781
BFCLPS6-0312-3500	5/16	3 1/2	3.281
BFCLPS6-0375-0750	3/8	3/4	0.515
BFCLPS6-0375-1000	3/8	1	0.765
BFCLPS6-0375-1125	3/8	1 1/8	0.890
BFCLPS6-0375-1250	3/8	1 1/4	1.015
BFCLPS6-0375-1375	3/8	1 3/8	1.140
BFCLPS6-0375-1625	3/8	1 5/8	1.390
BFCLPS6-0375-2000	3/8	2	1.765

Part number	Dia	Length	EL
BFCLPS6-0375-2750	3/8	2 3/4	2.515
BFCLPS6-0375-3000	3/8	3	2.765
BFCLPS6-0375-3500	3/8	3 1/2	3.265
BFCLPS6-0375-4000	3/8	4	3.765
BFCLPS6-0437-1500	7/16	1 1/2	1.265
BFCLPS6-0437-2000	7/16	2	1.765
BFCLPS6-0437-2500	7/16	2 1/2	2.265
BFCLPS6-0437-3000	7/16	3	2.765
BFCLPS6-0500-1250	1/2	1 1/4	1.015
BFCLPS6-0500-1500	1/2	1 1/2	1.265
BFCLPS6-0500-1750	1/2	1 3/4	1.515
BFCLPS6-0500-2000	1/2	2	1.765
BFCLPS6-0500-2500	1/2	2 1/2	2.265
BFCLPS6-0500-2750	1/2	2 3/4	2.515
BFCLPS6-0500-3000	1/2	3	2.765
BFCLPS6-0500-3500	1/2	3 1/2	3.265
BFCLPS6-0500-4000	1/2	4	3.765
BFCLPS6-0500-5000	1/2	5	4.765



Material:Type 316 Marine Grade Stainless Steel

Finish:Passivated



Buckeye Fasteners Company

5250 West 164th Street • Brook Park, Ohio 44142-1597

(800) 437-1689 • Fax: (216) 267-3228

buckeyefasteners.com • info@buckeyefasteners.com

© 2012 Buckeye Fasteners, Inc. All Rights Reserved

