

# Metric Piloted Hex Weld Nut With Six Projections

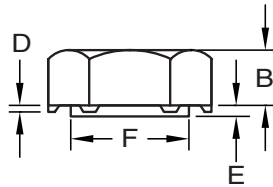
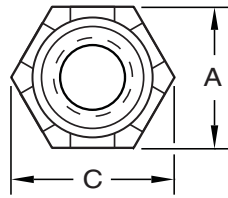

# Product Specification Sheet

Part Number	Thread Size	A Width Across Flats		B Thickness		C Width Across Corners Min.	D Proj. Height +/- 0.08	E Pilot. Height +/- 0.10	F Pilot Diameter +0.0 -0.3
		Max.	Min.	Max.	Min.				
HS6 M5	M5 X 0.8	11.00	10.73	4.8	4.4	12.1	0.39	0.90	7.55
HS6 M6	M6 X1	13.00	12.73	7.5	7.0	14.3	0.40	0.70	8.95
HS6 M6X							1.00	1.90	
HL6 M6							0.40	0.70	
HS6 M8	M8 X 1.25	15.00	14.73	8.5	8.0	16.6	0.40	0.70	10.95
HL6 M8	1.00						1.90		
HL6 M8X	0.40						0.70		
HS6 M10	M10 X 1.5	18.00	17.73	9.0	8.5	20.0	0.40	0.70	13.45
HL6 M10	1.00						1.90		
HL6 M10X	0.40						0.70		
HS6 M12	M12 X 1.75	21.00	20.67	11.0	10.5	23.3	0.65	1.15	15.93
HL6 M12	1.00						1.90		
<b>Austenitic Stainless Steel</b>									
HS6Z M8	M8 X 1.25	15	14.73	7.1	6.6	16	0.44	1.00	10.5

*X Indicates Import (Subject to a minimum ordering quantity)*



Six uniform projections ensure maximum contact with the weld surface. The precision pilot accurately locates the threads in the pilot hole and prevents the nut from slipping off center during welding. Available in two pilot heights to accommodate a variety of metal thicknesses.

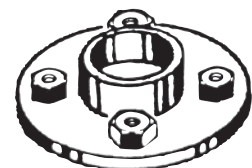

Material: .....C1010 High-Welding Quality, Low Carbon Steel

Finish: .....Plain, Unless Specified

Threads: .....ASME B1.13M-2005



## Buckeye Fasteners Company

5250 West 164th Street • Brook Park, Ohio 44142-1597

(800) 437-1689 • Fax: (216) 267-3228

buckeyefasteners.com • info@buckeyefasteners.com

© 2012 Buckeye Fasteners, Inc. All Rights Reserved

